

# CALM

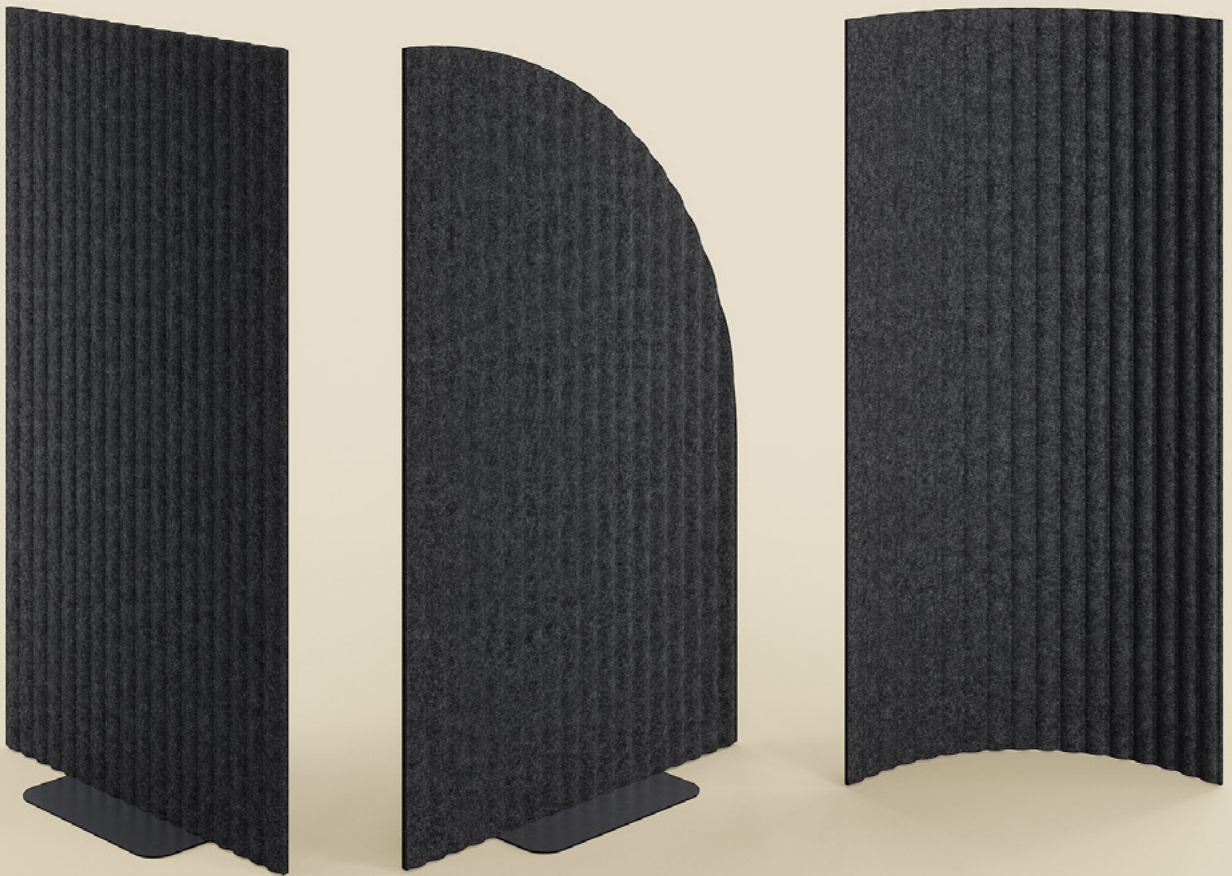

# CALM

## DESIGNER

- UNION Design

---

## LEAD TIME

- 5 days

## GSA

- Not available

---

## SPECIFICATIONS

### Base

- 1/8" steel plate in black powder coat
- Two vertical rods to hold screens in place

### Brackets

- Multiple joining bracket options to connect screens together

### Screens

- 3/4" thick pressed fluted PET felt
  - Integrated slots for joining brackets
  - Slides on top of base
- 

## ACOUSTICS

- NRC = 0.8
  - SAA = 0.77
- 

## REGULATORY

- California TB 117 2013
- 

## SUSTAINABILITY

Indoor Air Quality Gold Certified through SCS Global

### Steel

- 10% pre-consumer recycled content
- VOC-free powder coat

### PET Felt

- Made from recycled plastic
- 100% recyclable at end of life

### Cartons & Packaging

- 20% pre-consumer recycled content



## MODEL

### 8100-RDE | Straight Screen, Rounded End

---

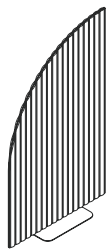

\$1834

*Dimensions (w x d x h)*

Screen | 36" x 0.75" x 60"

Base | 18" x 11"

*Shipping*

All pricing is FOB Louisville, KY.

Weight | 13lbs

LTL, UPS | 1/carton | 2.6 CF | 37" x 61" x 2"

## MODEL

### 8100-SQE | Straight Screen, Square End

---

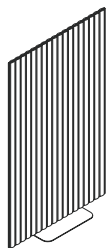

\$1707

*Dimensions (w x d x h)*

Screen | 36" x 0.75" x 60"

Base | 18" x 11"

*Shipping*

All pricing is FOB Louisville, KY.

Weight | 13lbs

LTL, UPS | 1/carton | 2.6 CF | 37" x 61" x 2"

## MODEL

### 8100-CRV | Curved Screen

---

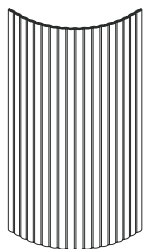

\$2359

*Dimensions (w x d x h)*

Overall | 21.3" x 21.3" x 60"

Radius | 34.5"

*Shipping*

All pricing is FOB Louisville, KY.

Weight | 13lbs

LTL, UPS | 1/carton | 14 CF | 36" x 61" x 11"

# CALM

## JOINING BRACKETS

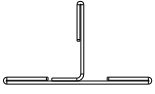

8100-X02  
T Connector  
\$30



8100-X03  
30° Angle Connector  
\$30

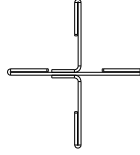

8100-X04  
X Connector  
\$30

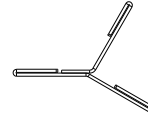

8100-X05  
Y Connector  
\$30



8100-X06  
Straight Connector  
\$30

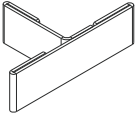

8100-X07  
U Connector  
\$30

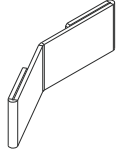

8100-X08  
90° Angle Connector  
\$30

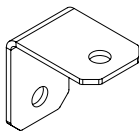
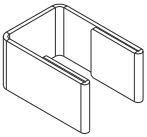
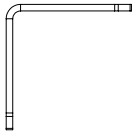
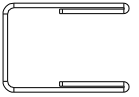

## EXAMPLE CONFIGURATIONS

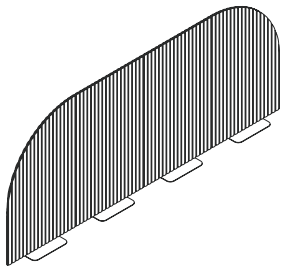

Straight

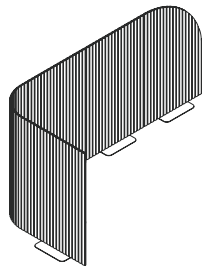

L-shaped

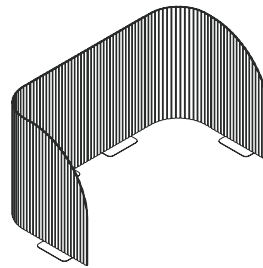

U-shaped

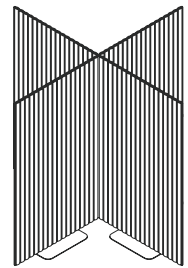

X-shaped

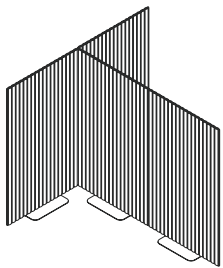

T-shaped

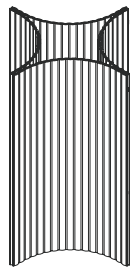

Star-shaped

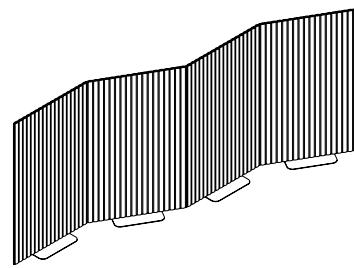

Zigzag

## ACOUSTICS

Noise Reduction Coefficient = 0.8  
 Sound Absorption Average = 0.77

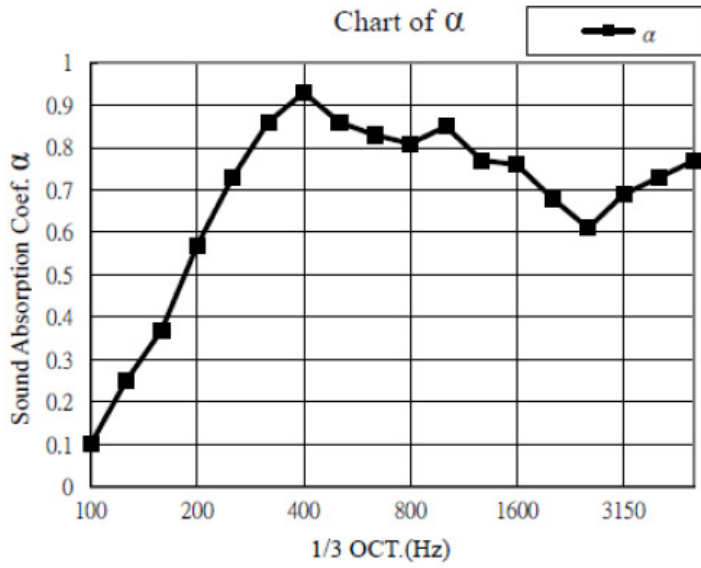

## FINISHES

### PET Felt

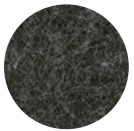

Charcoal  
A17

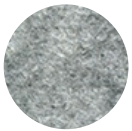

Grey  
A03



Stone  
FC2110

### Powder Coat



Black

## HOW TO SPECIFY

1. Select model #for screen.
2. Select PET felt color.
3. Select model # for brackets, if planning a configuration.